



Integra Ultrasonic Surgical Aspirator CUSA® Dissectron® Product Catalogue

Pricing:

Prices stated in specific written quotations are firm for thirty days from the date given, and are otherwise subject to change without prior notice. Pricing terms stated on written agreements are governed by such agreements.

Minimum Order Requirements:

Minimum order requirement is €250 (a €20 handling charge will be added to any order under €250).

Administrative fees:

For each order, an administrative fee amounting to €25, GBP25 or CHF30 will be applied.

Ordering Procedure:

A written purchase order on the customer's form may be requested for purchases of Integra LifeSciences products.

Acceptance of Orders:

Orders are accepted upon approval by Integra Customer Service.

Return Policy:

- Authorization from customer service must be obtained prior to returning product.
- Sterile product must be returned in unopened, undamaged cartons, packed to prevent damage.
- Non-sterile product must be returned in unused saleable condition in original package.
- Custom or special order products will not be accepted for credit.
- Credit will be issued for goods returned prior to ninety days from ship date with a 20% restocking charge. This assumes that the product returned is not damaged and can be verified to have not been used or opened.

INTEGRA Warranty for Cusa® Dissectron® Ultrasonic Surgical Aspirator

1. Warranty.

Integra Lifesciences Corporation and its wholly owned subsidiaries («Integra») warrant to Integra authorized distributors and the original purchaser only that each new Integra Cusa® Dissectron® Ultrasonic Surgical Aspirator (hereinafter the Equipment or the product) is free from manufacturing defects in material and workmanship under normal use and service for a period of one year (except as otherwise expressly provided as to accessory items) from the date of invoice by Integra (or its authorized distributor) to the original purchaser, but in no event beyond the expiration date stated on any product labeling (hereinafter the Warranty Period). For purposes of products sold by Integra through an authorized distributor of Integra, «original purchaser» shall include the purchaser of Integra products to whom the distributor first sells the product. The original purchaser is hereinafter referred to as Customer.

1.1. **Coverage.** During the Warranty Period, Integra shall provide free-of-charge service and maintenance consistent with the provisions of Section 3 of this Warranty, so that the Equipment conforms to the specifications defined in the Cusa® Dissectron® Ultrasonic Surgical Aspirator Operator's Manual, as such Operator's Manual may be modified by Integra from time to time (the "Specifications").

1.2. **Exclusions.** The Warranty shall not apply in any manner to service or maintenance of the Equipment, or to replacement of its parts, with respect to:

- use of Equipment with any tips and flues other than those manufactured by Integra LifeSciences;
- defects arising out of materials or parts provided, modified or designed by anyone other than an authorized Integra service agent (the Integra "Service Agent");
- defects emanating from improper or negligent installation, storage or use of the Equipment or any component thereof, including but not limited to operating the Equipment not in accordance with instructions provided in the Operator's Manual;
- defects arising from improper or negligent cleaning or sterilization

- defects resulting from repairs or service of the Equipment provided other than by Integra or its authorized representatives;
- defects arising from accidental damage to the Equipment, acts of God, electrical power damage, equipment malfunction, unusual stress, unreasonable operating procedures or abnormal or extreme operating conditions and normal wear and tear.

2. Service, Repairs and Replacement.

2.1. **Service and Repairs.** All service and repairs covered by this Warranty may be referred to hereinafter as "in-warranty repairs," and all service and repairs not covered by this Warranty may be referred to as "out-of-warranty repairs." Integra's sole obligation for in-warranty repairs shall be to make all necessary adjustments and repairs in accordance with this Warranty. Integra shall charge Customer at Integra standard rates for any out-of-warranty repair performed by Integra.

2.2. **Equipment Replacement.** The defective Equipment or part thereof that is replaced in accordance with the Warranty shall be the property of Integra. Integra reserves the right to fill spare parts requests using refurbished sub-assemblies provided that such sub-assemblies are functionally equivalent to new sub-assemblies and carry the same warranty as the replaced sub-assemblies.

2.3. **Notification.** In order to avail itself of its rights under the Warranty, Customer or Integra authorized distributors, must immediately notify Integra of any defects and provide Integra every opportunity to inspect and remedy defects.

Customer Service Contact Information :

International

+33 (0) 437 47 59 50
+33 (0) 437 47 59 25 (Fax)
csemea@Integralife.com

France

+33 (0) 437 47 59 10
+33 (0) 437 47 59 29 (Fax)
custsvcfrence@Integralife.com

Benelux

+32 (0) 2 257 4130
+32 (0) 2 253 2466 (Fax)
custsvcbenelux@Integralife.com

United Kingdom

+44 (0) 1264 345 780
+44 (0) 1264 363 782 (Fax)
custsvcsuk@Integralife.com

Germany

+49 (0) 2102 5535 6200
+49 (0) 2102 5536 636 (Fax)
custsvcgermany@Integralife.com

Switzerland

+41 22 721 23 30
+41 22 721 23 99 (Fax)
custsvcsuisse@Integralife.com

3. Repair Parts and Services.

3.1. Included under the Warranty are the following services :

- 3.1.1. *Consoles.* Integra shall, if possible, perform on-site repair of consoles or replace a console by a new or refurbished console (at the discretion of Integra), as the case may be, and where not possible Integra shall arrange and pay to ship the affected Equipment to the designated repair facility, and shall repair the affected Equipment.
- 3.1.2. *Handpieces.* Handpieces. Integra shall repair or replace any defective handpieces covered by the Warranty by a new or refurbished handpiece (at the discretion of Integra) that shall carry the same warranty as the original equipment (an "Exchange Handpiece").

3.2. *Modifications to Covered Equipment.* Modifications to Covered Equipment. From time to time, at its sole discretion, Integra may propose modifications to the covered Equipment and to the Specifications for the Equipment. Subject to Customer's approval and at its sole expense, the Customer may request Integra to make such modifications to the covered Equipment and to the Specifications. Integra shall make such modifications for the Customer, which modifications may include the installation of new parts in the Equipment, at a price equal to the then-current list price for such modifications, as such list price is established by Integra in its sole discretion.

4. Quality Control.

- 4.1. Customer shall maintain reasonable standards of quality control, operations, procedures, safety testing and inspection of Equipment to ensure that unnecessary service or maintenance is not required hereunder.
- 4.2. Customer shall provide a technical counterpart to Integras Service Agent for assistance in Integra's telephonic diagnosis of the malfunction with the Equipment. Customer shall reasonably accept Integra's determination whether a repair or service is an in-warranty repair or an out-of-warranty repair.

5. Limitation of Liability.

- 5.1. Integra's sole responsibility under the warranties described in Section 1 shall be repair or replacement, at Integras sole discretion at Integra's expense, subject to the terms of this warranty and applicable agreements. THE WARRANTIES DESCRIBED IN SECTION 1 HEREOF ARE EXCLUSIVE AND ARE GIVEN AND ACCEPTED IN LIEU OF ALL OTHER WARRANTIES OF INTEGRA OR ITS SERVICE AGENTS WITH RESPECT TO THE QUALITY, PERFORMANCE AND OPERATION OF THE EQUIPMENT, WRITTEN OR ORAL, EXPRESS OR IMPLIED, AND WHETHER OR NOT ATTRIBUTABLE TO SERVICE PERFORMED PURSUANT TO THE WARRANTY. ALL OTHER REPRESENTATIONS OR WARRANTIES OF INTEGRA OR ITS REPRESENTATIVES, EXPRESS OR IMPLIED, WITH RESPECT TO THE EQUIPMENT OR THE SERVICES, DIAGNOSIS, ADVICE, ASSISTANCE OR PARTS TO BE TENDERED PURSUANT TO THE WARRANTY, INCLUDING, WITHOUT LIMITATION, THOSE OF MERCHANTABILITY AND FITNESS FOR A PARTICULAR PURPOSE, ARE HEREBY EXPRESSLY DISCLAIMED. IN NO EVENT SHALL INTEGRA, ITS ASSIGNEES OR SERVICE AGENTS BE LIABLE FOR LOSS OF USE, REVENUE OR PROFIT OR ANY OTHER INDIRECT, INCIDENTAL, EXEMPLARY, CONSEQUENTIAL, SPECIAL OR OTHER DAMAGES, WHETHER ARISING IN CONTRACT OR IN TORT, BY VIRTUE OF THE WARRANTY OR ANY PERFORMANCE OR BREACH BY INTEGRA, ITS ASSIGNEES OR SERVICE AGENTS HEREUNDER OR PURSUANT HERETO.
- 5.2. Customer agrees that, notwithstanding the technical assistance provided pursuant to the Warranty by Integra or its representatives, Customer shall be fully and solely responsible for all treatments performed or attempted with the Equipment. INTEGRA MAKES NO REPRESENTATION OR WARRANTY AS TO THE EFFICACY OF THE EQUIPMENT OR OF THE TECHNICAL ASSISTANCE TO BE RENDERED BY INTEGRA, ITS ASSIGNEES OR SERVICE AGENTS, FOR

PURPOSES OF THE PARTICULAR TREATMENT THAT CUSTOMER INTENDS TO PERFORM FOR THIRD PARTIES. Moreover, Integra disclaims any liability with respect to the efficacy of the Equipment or of said technical assistance or with respect to any claims by third parties related to any treatment performed by Customer.

5.3. THIS INTEGRA LIMITED WARRANTY IS EXCLUSIVE AND IN LIEU OF ALL OTHER WARRANTIES, EXPRESS OR IMPLIED, AND OF ALL OTHER OBLIGATIONS OR LIABILITIES ON INTEGRA'S PART OR THE PART OF ITS DISTRIBUTORS, AND INTEGRA NEITHER ASSUMES NOR AUTHORIZES ANY REPRESENTATIVE OR OTHER PERSON TO ASSUME FOR IT ANY OTHER LIABILITY IN CONNECTION WITH INTEGRA'S PRODUCTS.

INTEGRA DISCLAIMS ALL OTHER WARRANTIES, EXPRESS OR IMPLIED INCLUDING ANY IMPLIED WARRANTY OF MERCHANTABILITY OR OF FITNESS FOR A PARTICULAR PURPOSE OR APPLICATION OR WARRANTY OF QUALITY AS WELL AS ANY EXPRESS OR IMPLIED WARRANTY TO PATIENTS. No warranty or guarantee may be created by any act or statement nor may this Standard Warranty be modified in any way, except as a result of a writing signed by an officer of Integra. These limitations on the creation or modification of this warranty may not be waived or modified orally or by any conduct.

5.4. IN NO EVENT SHALL INTEGRA AUTHORIZED DISTRIBUTORS BE LIABLE TOWARDS CUSTOMER FOR ANY INCIDENTAL, INDIRECT, CONSEQUENTIAL OR PUNITIVE DAMAGES IN CONNECTION WITH THE ACQUISITION OR USE OF ANY INTEGRA PRODUCT. Further, this warranty shall not apply to, and INTEGRA authorized distributors shall not be responsible towards Customer for, any loss, arising in connection with the purchase or use of any Integra product that has been repaired by anyone other than an authorized Integra service representative or altered in any way so as to affect its stability or reliability, or which has been subject to misuse, negligence or accident, or which has been used otherwise than in accordance with the instructions furnished by INTEGRA. THIS INTEGRA DISTRIBUTOR LIMITED WARRANTY IS EXCLUSIVE AND IN LIEU OF ALL OTHER WARRANTIES TOWARDS CUSTOMER, EXPRESS OR IMPLIED, AND OF ALL OTHER OBLIGATIONS OR LIABILITIES TOWARDS CUSTOMER ON INTEGRA AUTHORIZED DISTRIBUTOR'S PART. INTEGRA AUTHORISED DISTRIBUTORS DISCLAIM ALL OTHER WARRANTIES TOWARDS CUSTOMER, EXPRESS OR IMPLIED INCLUDING ANY IMPLIED WARRANTY OF MERCHANTABILITY OR OF FITNESS FOR A PARTICULAR PURPOSE OR APPLICATION OR WARRANTY OF QUALITY AS WELL AS ANY EXPRESS OR IMPLIED WARRANTY TO PATIENTS OR OTHER THIRD PARTIES.

5.5. Force Majeure. Notwithstanding anything to the contrary herein contained, if the performance of the Warranty by Integra, Integra authorized distributors, or Customer or any obligation of Integra, Integra authorized distributors, or Customer hereunder is prevented, restricted or interfered with by reason of fire, explosion, act of God, labor disputes or accidents affecting performance under the Warranty, or war, mobilization, civil commotions, blockade or embargo, or any future law, regulation, ordinance or requirement of any government or regulatory agency or any other act, whatsoever similar to those above enumerated, or any other circumstance being beyond the reasonable control of Integra, Integra authorized distributors, or Customer, then and in that event Integra, Integra authorized distributors, or Customer, as the case may be, shall promptly notify the other party hereto of the difficulties resulting therefrom, and any of the foregoing events shall excuse any performance required under the Warranty.

Recommended Starting Sets



Catalog No.	Description	Quantity for Neuro Use	Quantity for Liver Use
X74110	CUSA® Dissectron® Console with Transport Container	1	1
E74203	Footswitch	1	1
X75633	Serum Holder	1	1
F75230	Trolley	1	1
5557540	Power Cord, Europe	1	1
5557539	Power Cord, United-Kingdom		
F75120	FingerTip Straight Handpiece		1
F75130	FingerTip Curved Handpiece	1	1
F75140	Penstyle Handpiece with cable	1	
F75125	FingerTip Handpiece Cord	1	2
F75600	FingerTip Titan Select Tip	1	1
F75601	FingerTip Golden Power Tip		1
F75605	Penstyle Micro Tip	1	
F75225	Penstyle Micro Tip Sterile Flues	1 BOX 5	
F75226	FingerTip Sterile Flues for Golden & Titan Tips	1 BOX 5	2 BOX 5
X75147	Penstyle Wrench	1	
E74217	FingerTip Wrench 6 mm (1 of 2)	1	2
E74218	FingerTip Wrench 8 mm (2 of 2)	1	2
F75521	Sterile Tubing Kits	1 BOX 5	1 BOX 5
F75940	Penstyle Sterilization Case	1	
F75920	FingerTip Sterilization Case	1	2
E74216	Filters for Sterilization Case	1 BOX of 100	1 BOX of 100
A750006	OR Suction Tubing - <i>to Connect Console to Vacuum</i>	1	1
E32129	OR Suction Connector - <i>to Connect to Vacuum</i>	1	1
E74230	Canister Suction Tubing - <i>to Connect Console to Canister</i>	1	1
E75348	Receptacle Canister 2L	1	1
E75367	Receptacle Holder	1	1

FingerTip Handpieces



FingerTip Straight Handpiece



FingerTip Curved Handpiece



Golden Power Tip



Titan Select Tip



Micro Tip

Catalog No.	Description	Quantity
F75120	FingerTip Straight Handpiece	EACH 1
F75130	FingerTip Curved Handpiece	EACH 1
F75601	FingerTip Golden Power Tip	EACH 1
F75600	FingerTip Titan Select Tip	EACH 1
F75604	FingerTip Micro Tip	EACH 1
F75226	FingerTip Sterile Flues for Golden & Titan Tips	BOX 5
F75223	FingerTip Sterile Flues for Micro Tip	BOX 5
E74217	FingerTip Wrench 6 mm (1 of 2)	EACH 1
E74218	FingerTip Wrench 8 mm (2 of 2)	EACH 1
F75125	FingerTip Handpiece Cord	EACH 1
F75521	Sterile Tubing Kits	BOX 5
F75910	FingerTip Handpiece Cleaning Brushes	BOX 10
F75918	FingerTip Micro Tip Cleaning Brushes (2 mm)	BOX 5
F75919	FingerTip Golden and Titan Tips Cleaning Brushes (2,5 mm)	BOX 5
F75920	FingerTip Sterilization Case	EACH 1
E74216	Filters for Sterilization Case	BOX 100

FingerTip Laparoscopic and ENT Extensions



Laparoscopic Extension

Catalog No.	Description	Quantity
F75224	FingerTip Laparoscopic Extension*	EACH 1
F75214	FingerTip ENT Extension*	EACH 1
E75917	FingerTip Extensions Wrench	EACH 1
F75221	FingerTip Laparoscopic Sterile Flues	BOX 5
F75210	FingerTip ENT Sterile Flue	EACH 1

*Laparoscopic and ENT extensions are recommended for use with the FingerTip Straight Handpiece.

Penstyle Handpiece



Penstyle Handpiece



Penstyle Micro Tip

Catalog No.	Description	Quantity
F75140	Penstyle Handpiece with cable	EACH 1
F75605	Penstyle Micro Tip	EACH 1
X75147	Penstyle Wrench	EACH 1
F75225	Penstyle Micro Tip Sterile Flues	BOX 5
F75521	Sterile Tubing Kits	BOX 5
F75918	Penstyle Micro Tip Cleaning Brushes (2 mm)	BOX 5
F75919	Penstyle Handpiece Cleaning Brushes (2,5 mm)	BOX 5
F75940	Penstyle Sterilization Case	EACH 1
E74216	Filters for Sterilization Case	BOX 100

Replacement Parts

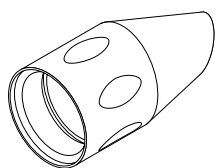

FingerTip Green Cone

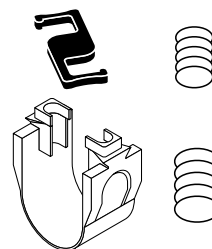

Plastic part and O'rings

Catalog No.	Description	Quantity
F75207	FingerTip Green Cone	EACH 1
F75321	Plastic part and O'rings	EACH 1

Console and Accessories

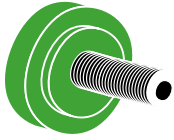

OR Suction Connector

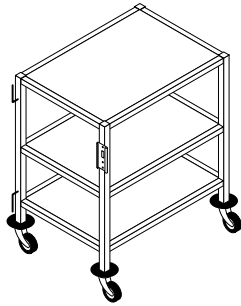

Trolley



Receptacle Holder

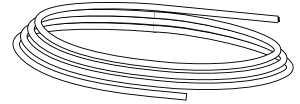

OR Suction Tubing 6 m

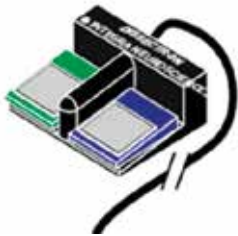

Footswitch



Receptacle Canister 2L



Serum Holder

Catalog No.	Description	Quantity
X74110	CUSA® Dissectron® Console with Transport Container	EACH 1
E74203	Footswitch	EACH 1
X75633	Serum Holder	EACH 1
5557540	Power Cord, Europe	EACH 1
5557539	Power Cord, United-Kingdom	EACH 1
A750006	OR Suction Tubing 6 m - <i>to Connect Console to Vacuum</i>	EACH 1
E32129	OR Suction Connector - <i>to Connect to Vacuum</i>	EACH 1
E74230	Canister Suction Tubing - <i>to Connect Console to Canister</i>	EACH 1
F75230	Trolley	EACH 1
E75367	Receptacle Holder	EACH 1
E75348	Receptacle Canister 2L	EACH 1



Distributed by

Integra LifeSciences Services (France) SAS
Sales & Marketing EMEA
Immeuble Séquoia 2 • 97 allée Alexandre Borodine
Parc technologique de la Porte des Alpes
69800 Saint Priest • FRANCE
Phone: +33 (0)4 37 47 59 00 phone • Fax: +33 (0)4 37 47 59 99
emea.info@integralife.com • integralife.eu

 Integra NeuroSciences Limited
Newbury Road
Andover - Hampshire SP10 4DR, UK

Customer Services

International: +33 (0)4 37 47 59 50 • +33 (0)4 37 47 59 25 (Fax) • csema@integralife.com
France: +33 (0)4 37 47 59 10 • +33 (0)4 37 47 59 29 (Fax) • custsvcf@integralife.com
United Kingdom: +44 (0)1 264 345 780 • +44 (0)1 264 363 782 (Fax) • custsvcs.uk@integralife.com
Germany: +49 (0) 2102 5535 6200 • +49 (0)2 102 5536 636 (Fax) • custsvcg@integralife.com
Benelux: +32 (0)2 257 4130 • +32 (0)2 253 2466 (Fax) • custsvcbenelux@integralife.com
Switzerland: +41 (0)2 27 21 23 30 • +41 (0)2 27 21 23 99 (Fax) • custsvcsuisse@integralife.com